

1/2 earthbag community

House community made of bags filled with local materials.

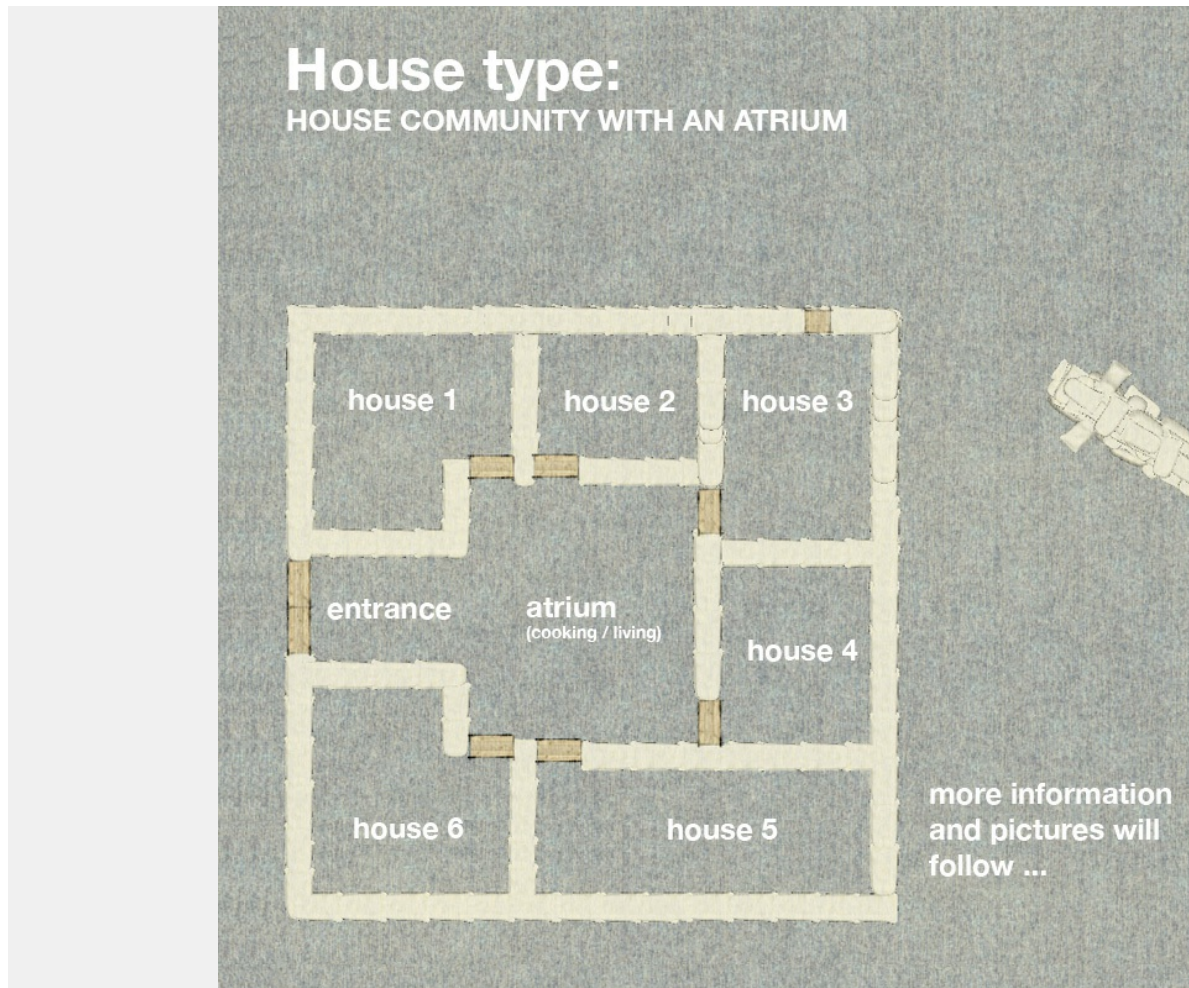

Solution

COST REPORT:

dimensions of the building:
community building: 12,5 m x 12,5 m = 156,25 sq.m
atrium: 6 m x 6 m = 36 sq. m

120,25 sq.m minus space for walls =
100 sq.m living space for 7 living quarters

altogether walls: 100 m (length) x
2,5 m (height)

dimensions of the bags:
filled compressed bag: 0,5 m
(length) x 0,15 m (height)

How many bags will we need:
Height: 2,5 m : 0,15 m = 16 rows of
bags
Length: 100 m : 0,50 m = 200 bags
per row

16 x 200 = 3200 bags

The bags usually come in bales of
1,000 (\$ 100,- + \$ 40,- shipping)
\$ 0,14/bag (incl. shipping) = \$ 448,-

'The \$300 House' Challenge

2/2

earthbag community

House community made of bags filled with local materials.

Creative's profile



iLINES PRO
Designer

Creative's top 5 skills

Graphic Design, Product Design, Communication Concept