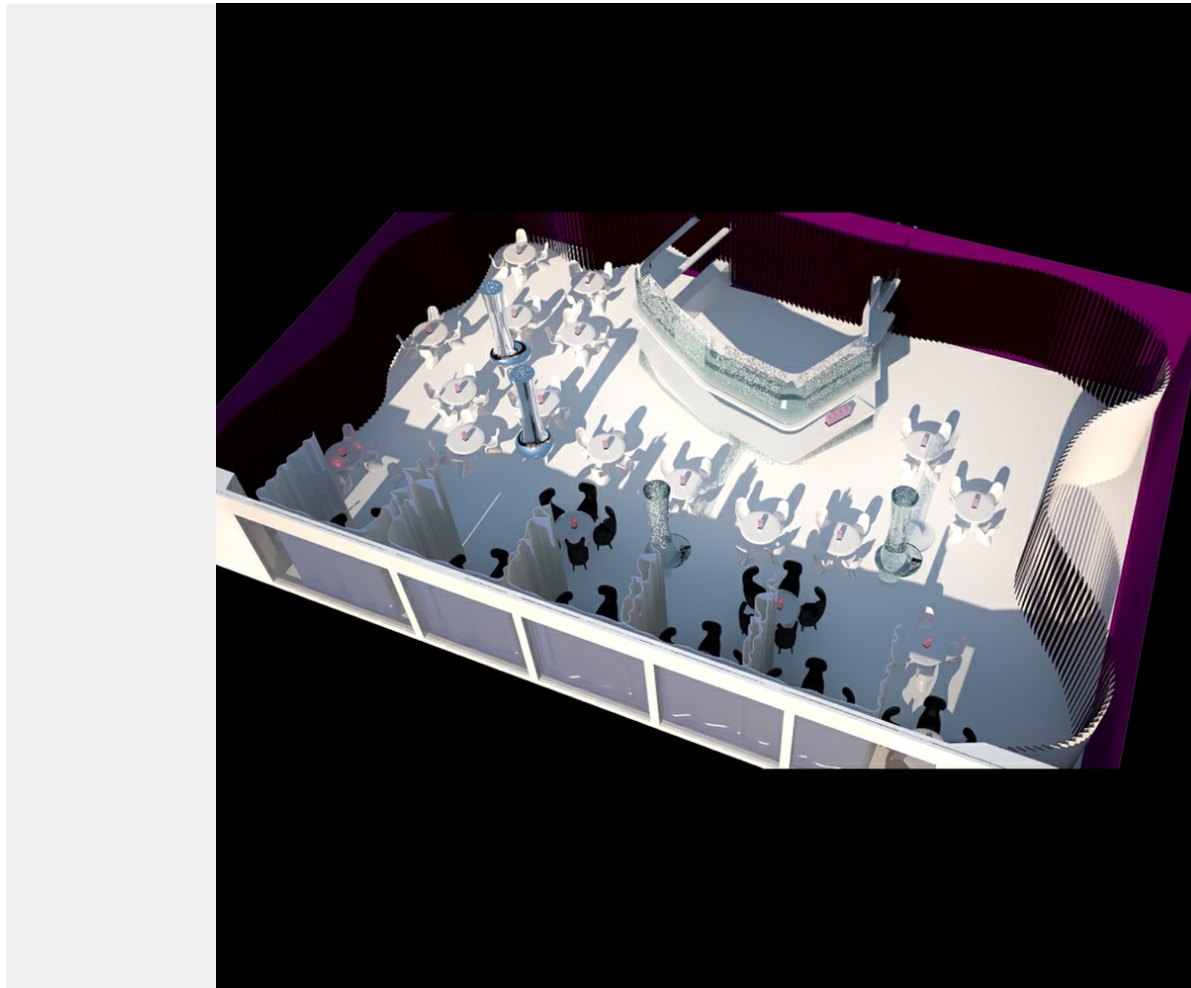

1/2 **SmSd (Smart Materials - Smart Design)**

Smart materials are often considered to be a logical extension of the trajectory in materials development toward more selective and specialized performance.

**Solution**

Smart planes ♦ intelligent houses  
♦ shape memory textiles ♦  
micromachines ♦ self-assembling  
structures ♦ color-changing  
paint ♦ nanosystems. The  
vocabulary of the material world  
has  
changed dramatically since 1992,  
when the first ♦ smart  
material ♦ emerged commercially  
in, of all things, snow skis.  
Defined as ♦ highly engineered  
materials that respond intelligently  
to their environment ♦, smart  
materials have become  
the ♦ go-to ♦ answer for the 21st  
century ♦s technological needs.  
Smart materials are often  
considered to be a  
logical extension of the trajectory in  
materials development  
toward more selective and  
specialized performance. For many  
centuries one had to accept and  
work with the properties of a  
standard material such as wood or  
stone, designing to  
accommodate the material ♦s

2/2

## SmSd (Smart Materials - Smart Design)

Smart materials are often considered to be a logical extension of the trajectory in materials development toward more selective and specialized performance.

Creative's profile

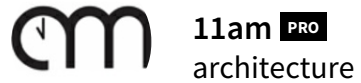

Creative's top 5 skills

Architecture, Graphic Design, Photography, Product Design