

1/2 Feel the green

Accommodation modules immersed in green areas.

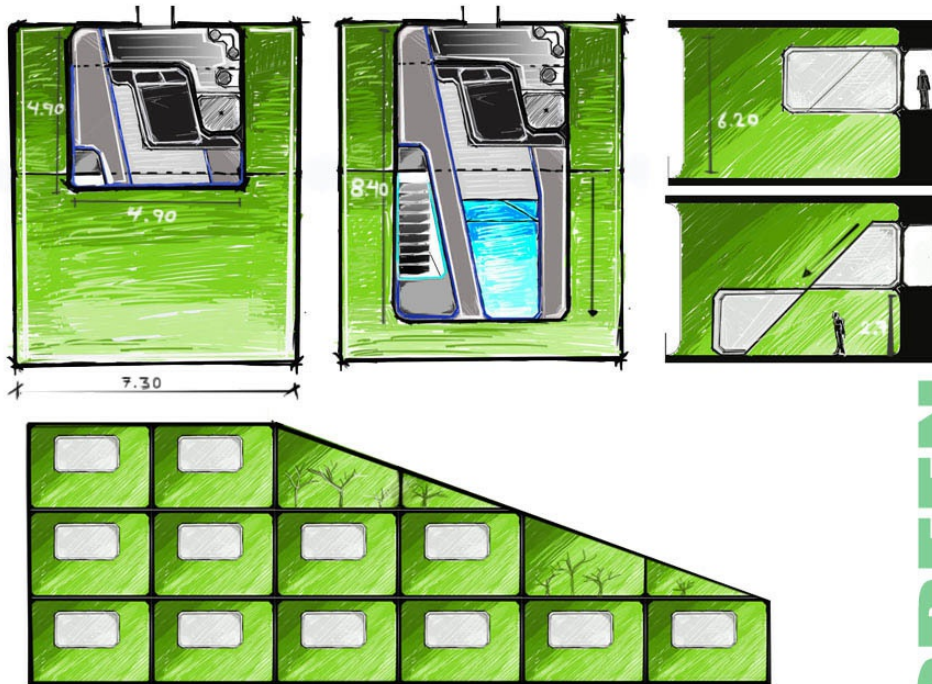

In a world where cities are increasingly moving away from nature and where green areas are contained in isolated spaces due to the constant increase in population density, we are trying to integrate plants into everyday life.

Our proposal is not limited to projecting holograms of augmented reality and images of artificial environments, but goes a step further and introduces the green areas to the immediate environment of the hotel room, turning it into a habitat for travelers.

These modules are more than a simple room to spend the night due to being surrounded by green areas, which are maintained by renewable energy, providing the user comfort during their stay.

FEEL THE GREEN

Solution

In a world where cities are increasingly moving away from nature and where green areas are contained in isolated spaces due to the constant increase in population density, we are trying to integrate plants into everyday life.

Our proposal is not limited to projecting holograms of augmented reality and images of artificial environments, but goes a step further and introduces the green areas to the immediate environment of the hotel room, turning it into a habitat for travelers.

These modules are more than a simple room to spend the night due to being surrounded by green areas, which are maintained by renewable energy, providing the user comfort during their stay.

Room 2022



2/2

Feel the green

Accommodation modules immersed in green areas.

Creative's profile



KROM PRO
architect

Creative's top 5 skills

Graphic Design, Illustration, Photography, Product Design