

1/7 **3PORT**

3PORT - Think simple, multi and functional.

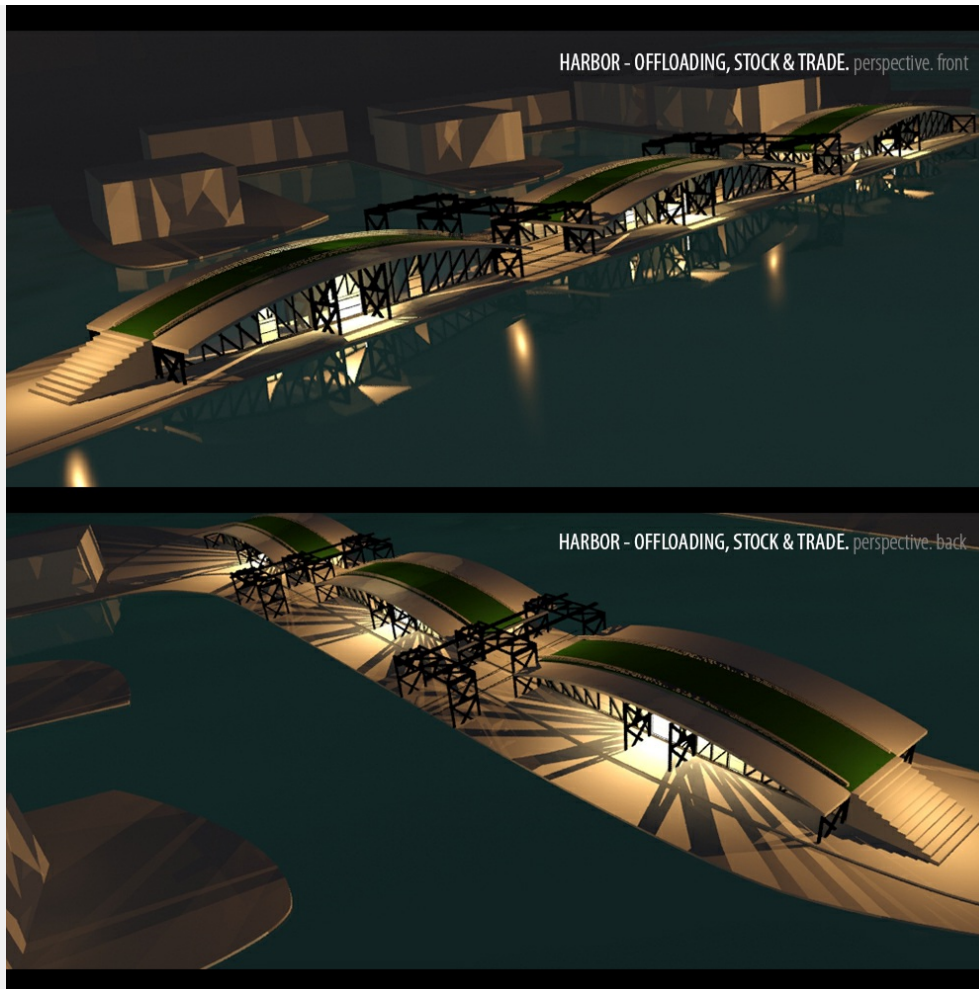

Solution

3PORT is a multifunctional space. It is for OFFLOADING, TRADE, FAIRS & EVENTS with a ROOF VIEW. It connects people from the river and the mainland. So the 3PORT get back the function of the old bridge. It also covers the port and make the port also more beautiful. A port is the first place, where tourist enter the city.

Status: 19.06.2018

2/7

3PORT

3PORT - Think simple, multi and functional.

What is the name of your concept?

3PORT - Think simple, multi and functional.

3/7

3PORT

3PORT - Think simple, multi and functional.

Which of the three suggested areas are you choosing for your concept? (the Donaulände public park, the port area or the mouth of Traun River)?

THE PORT AREA - A port is also a bridge. Think simple, multi and functional.

4/7

3PORT

3PORT - Think simple, multi and functional.

What is the public function of your concept?

OFFLOADING, STOCK & TRADE with a ROOF VIEW. It is a multifunctional space for connecting people from the river and the mainland. But it can be also connect the people of Linz and people from the outside.

5/7

3PORT

3PORT - Think simple, multi and functional.

How are the parts of the old railway bridge visible in your concept?

All steel elements will be used and will be visible the old structure of the bridge. It is important to keep the basic structure to preserve the history of the bridge and Linz. The bridge is a memory of the power of construction from the past.

6/7

3PORT

3PORT - Think simple, multi and functional.

Have you used any third-party material? Even if you've modified it, source the original here. See FAQ for details.

no

7/7

3PORT

3PORT - Think simple, multi and functional.

Creative's profile



youdo PRO

Designer, Developer, Programmer Artist

Creative's top 5 skills

Mobile Apps, Product Design