

1/2 NYC S,M,L,XL

NYC Small, Medium, Large, Extra-Large

8 FURNITURE MODULE - COMPUTER CONSOLE - BUNK BEDS

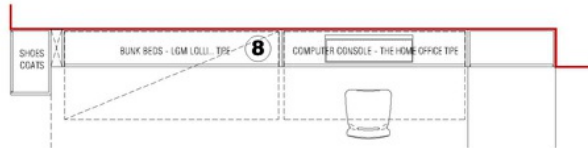

COMPUTER CONSOLE

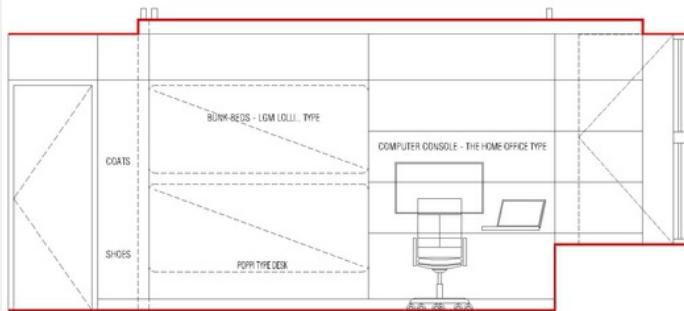

FRONT VIEW

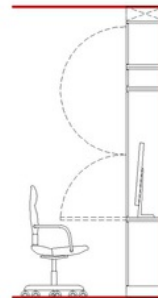

COMPUTER CONSOLE



BUNK BEDS



POPPI TYPE DESK

Solution

I tried to create a multifunctional space that will support all the requested functions offering them the maximum space available by easily moving some furniture and some partition panels. In order to get this I grouped - as compact as possible - the wet spaces (kitchen and bathroom) near to the existing installation shafts. They are located out of the way, in one of the most disadvantaged part of the apartment (regarding the view and orientation), so that their users do not have to interfere one with each other. I also lowered the ceiling for HVAC installations. Therefore the resulting height in the entire apartment is approx. 2.50m. By doing that, the remaining space can be easily modified according to the activities mentioned in the brief. The partitions are created in such a way, that even if this apartment is simultaneously used by 4 persons, each of them will have intimacy and will not disturb the others. In the same time it is easy enough to modify the entire apartment, so

2/2

## NYC S,M,L,XL

NYC Small, Medium, Large, Extra-Large

Creative's profile



flav\_660029 **PRO**  
Architect

Creative's top 5 skills

Graphic Design, Illustration, Photography, Product Design, Interior Design